

内徑車刀 Micro Bar-Boring

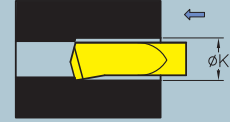
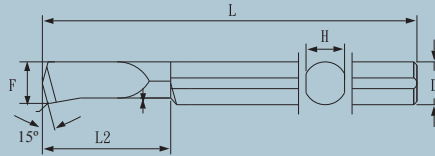
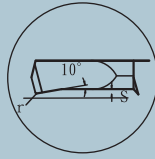
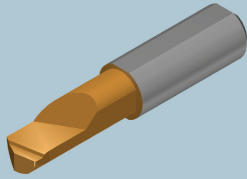

型號 EDP NO.	ØK	F	L2	L	r	S	ØD	在庫 stock	適用套筒 Applicable Sleeve
45.2006-005	2	1.8	6.0	40	0.05	0.3	4		SP.250-04** SP.5650-04**
45.2010-005	2	1.8	10.0	40	0.05	0.3	4		
45.2014-005	2	1.8	14.0	45	0.05	0.3	4		
45.3009-01	3	2.8	9.0	40	0.1	0.3	4		
45.3015-01	3	2.8	15.0	45	0.1	0.3	4		
45.3021-01	3	2.8	21.0	52	0.1	0.3	4		
45.4012-02	4	3.8	12.0	42	0.2	0.5	4		
45.4020-02	4	3.8	20.0	50	0.2	0.5	4		
45.4028-02	4	3.8	28.0	60	0.2	0.5	4		
45.5015-02	5	4.8	15.0	50	0.2	0.5	6		SP.250-06** SP.5650-06**
45.5025-02	5	4.8	25.0	60	0.2	0.5	6		
45.5035-02	5	4.8	35.0	70	0.2	0.5	6		
45.6020-02	6	5.8	29.0	55	0.2	0.5	6		
45.6030-02	6	5.8	30.0	65	0.2	0.5	6		
45.6042-02	6	5.8	42.0	77	0.2	0.5	6		SP.250-08** SP.5650-08**
45.7021-02	7	6.8	21.0	60	0.2	0.5	8		
45.7035-02	7	6.8	35.0	75	0.2	0.5	8		
45.7049-02	7	6.8	49.0	90	0.2	0.5	8		
45.8025-02	8	7.8	25.0	65	0.2	0.7	8		
45.8040-02	8	7.8	40.0	80	0.2	0.7	8		
45.8056-02	8	7.8	56.0	100	0.2	0.7	8		

無"●"標示者為訂製品。Without "●" marking means custom products.
 有"●"標示者為在庫品。With "●" marking means items in stock.

内徑車刀 Micro Bar-Boring

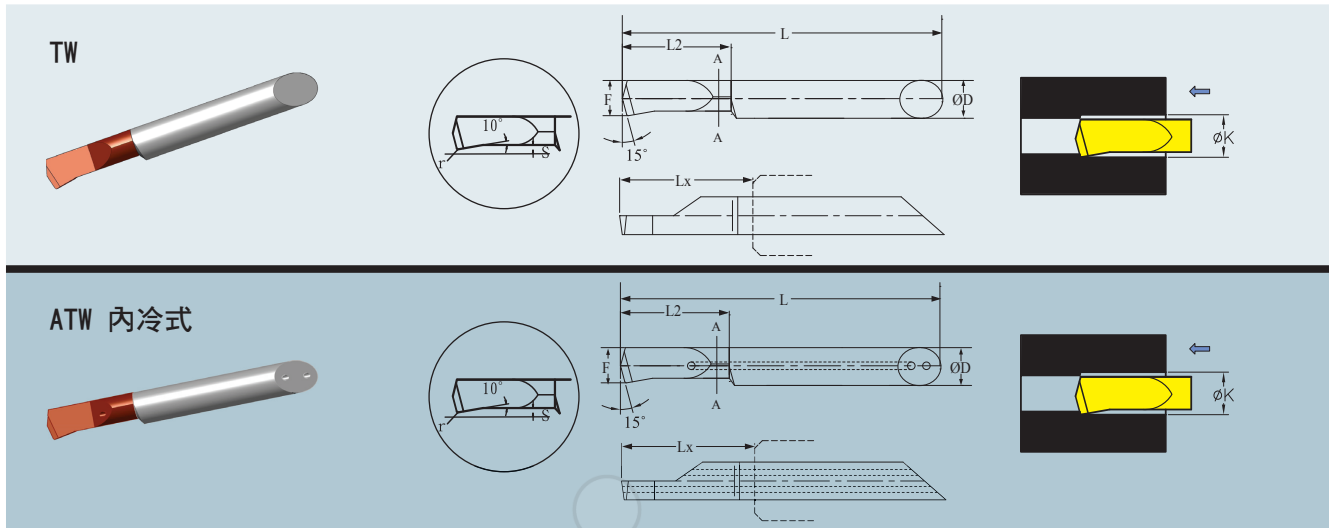

型號 EDP NO.	内冷式 型號 EDP NO.	ØK	F	L2	Lx	r	S	ØD	在庫 stock	適用套筒 Applicable Sleeve
TW 45.2006-005	ATW 45.2006-005	2	1.8	6.0	8.0	0.05	0.3	4		SP.380-04**
TW 45.2010-005	ATW 45.2010-005	2	1.8	10.0	12.0	0.05	0.3	4		
TW 45.2014-005	ATW 45.2014-005	2	1.8	14.0	16.0	0.05	0.3	4		
TW 45.3009-01	ATW 45.3009-01	3	2.8	9.0	11.0	0.1	0.3	4		
TW 45.3015-01	ATW 45.3015-01	3	2.8	15.0	17.0	0.1	0.3	4		
TW 45.3021-01	ATW 45.3021-01	3	2.8	21.0	23.0	0.1	0.3	4		
TW 45.4012-02	ATW 45.4012-02	4	3.8	12.0	14.0	0.2	0.5	4		
TW 45.4020-02	ATW 45.4020-02	4	3.8	20.0	22.0	0.2	0.5	4		
TW 45.4028-02	ATW 45.4028-02	4	3.8	28.0	30.0	0.2	0.5	4		
TW 45.5015-02	ATW 45.5015-02	5	4.8	15.0	17.0	0.2	0.5	5		SP.380-05**
TW 45.5025-02	ATW 45.5025-02	5	4.8	25.0	27.0	0.2	0.5	5		
TW 45.5035-02	ATW 45.5035-02	5	4.8	35.0	37.0	0.2	0.5	5		
TW 45.6020-02	ATW 45.6020-02	6	5.8	20.0	23.0	0.2	0.5	6		SP.380-06**
TW 45.6030-02	ATW 45.6030-02	6	5.8	30.0	33.0	0.2	0.5	6		
TW 45.6042-02	ATW 45.6042-02	6	5.8	42.0	45.0	0.2	0.5	6		
TW 45.7021-02	ATW 45.7021-02	7	6.8	21.0	24.0	0.2	0.5	7		SP.380-07**
TW 45.7035-02	ATW 45.7035-02	7	6.8	35.0	38.0	0.2	0.5	7		
TW 45.7049-02	ATW 45.7049-02	7	6.8	49.0	52.0	0.2	0.5	7		
TW 45.8024-02	ATW 45.8024-02	8	7.8	24.0	27.0	0.2	0.7	8		SP.380-08**
TW 45.8040-02	ATW 45.8040-02	8	7.8	40.0	43.0	0.2	0.7	8		
TW 45.8056-02	ATW 45.8056-02	8	7.8	56.0	59.0	0.2	0.7	8		

無"●"標示者為訂製品。Without "●" marking means custom products.
 有"●"標示者為在庫品。With "●" marking means items in stock.